

# HOLLAND Fifth Wheels

## Cold Weather Inspection and Maintenance Tips



Routine inspection and maintenance of the fifth wheel during extreme cold weather. It is important to understand how the wheel operates, and that all parts and adjustments are maintained to factory specifications. Proper lubrication and adjustments are critical to the proper performance of the fifth wheel. Special precautions should be taken at low temperatures to ensure that the fifth wheel locking mechanism operates freely. If you are in a region that experiences extreme weather with freezing temperatures (below 0°F), ice and sludge can build up, and lubricants can become thick and binding. Follow the recommended cleaning procedures.

The kingpin and upper coupler of the trailer should be maintained to the proper dimensions of the kingpin, ensuring that they are within specification and that the deflection or wear is within the stated OOS criteria stated both by SAE and DOT. Remove all snow, ice, and debris from the fifth wheel especially on the throat area, and remove hardened lubricants that bind the locking mechanism.

Here are some basic tips for HOLLAND fifth wheels.

**To get the maximum service life, perform the steps below at the intervals shown:**

1. Lubricate the locking mechanism every 3 months or 30,000 miles, whichever comes first.
2. Thoroughly clean the locking mechanism every 6 months or 60,000 miles, whichever comes first.
  - a. Clean all moving components and spray with WD-40 or CRC.

**PLEASE NOTE:** Road salts for snow removal in cold climates can inadvertently cause corrosion on tractor and trailer components. The corrosion will affect a semi truck's fifth wheel performance if left unchecked.

**Proper lubrication procedures include the following:**

1. Removing old grease and debris from all fifth wheel-to-trailer contact surfaces.
2. Applying new water-resistant lithium-based grease to all fifth wheel-to-trailer contact surfaces.
3. Keep in mind that there are differences in lubrication needs and intervals depending on whether you have a standard, greased fifth wheel, or a NoLube version.

**IMPORTANT:** Lubricate fifth wheel locking mechanism according to instructions in your fifth wheel manufacturer's User Manual.

**WARNING:** You should never attempt to couple a fifth wheel that has snow, ice, or debris in the throat area. Improper coupling can occur possibly resulting in serious injury or death.

**IMPORTANT:** NEVER use aftermarket add on lube plates as they will alter the proper kingpin depth when coupled into the fifth wheel locks. The use of add-on lube plates will void the fifth wheel top plate warranty.

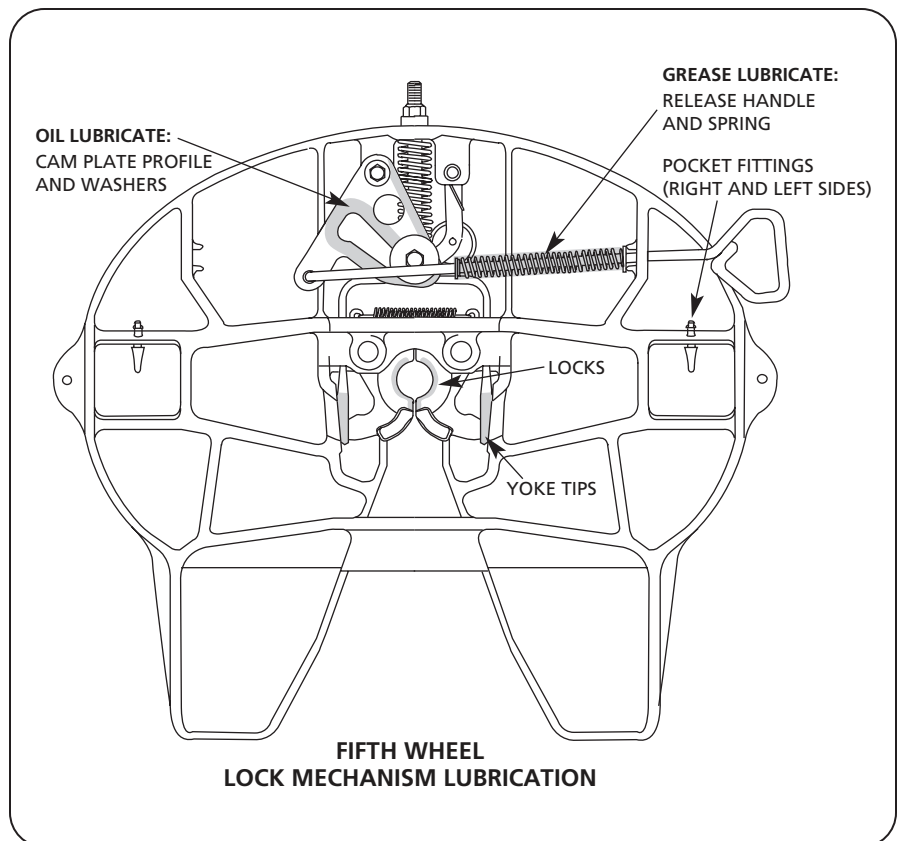

For more HOLLAND Fifth Wheel information.



# HOLLAND Fifth Wheels

## Proper Slider Maintenance and Operation Tips



Sliders should be periodically maintained.

Pressure washing slide racks can remove debris that may inhibit full plunger engagement. Activation of slide cylinder may be improved by adding tool oil to internals and cycling.

**Slider brackets must be confirmed to be properly engaged after each slide repositioning.**

The image depicts what a properly engaged Holland slider looks like. When plungers are engaged in slide rack (air cylinder not energized) the slider spring will push the plungers until they are flush or up to 1/4" from flush with the inside edge of the slider mounting bracket. Do not operate the vehicle if plungers are not fully engaged.

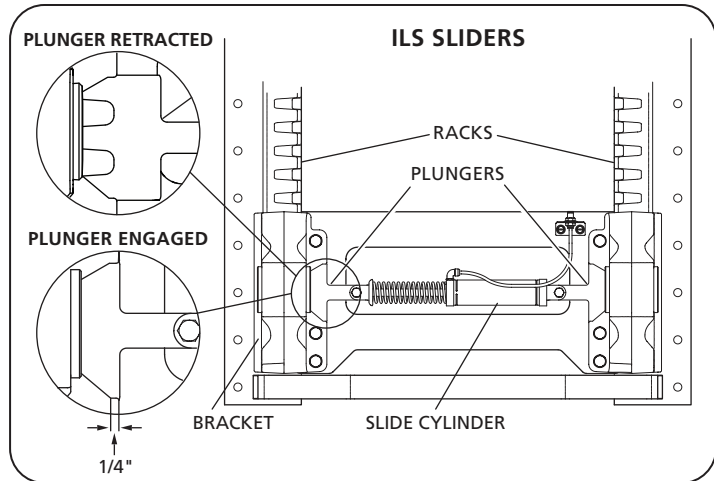

A final check for bracket and bushing wear can be done by prying up on the fifth wheel top plate as shown to the right. If upward movement is greater than 1/4", the top plate should be removed for further inspection. Please refer to Owner's Manual for additional information.

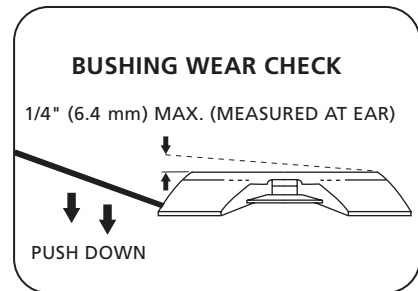

During an inspection, it is critical for the driver to understand how the fifth wheel locks and unlocks.

**The driver can identify that the fifth wheel is securely locked with these three visual checks:**

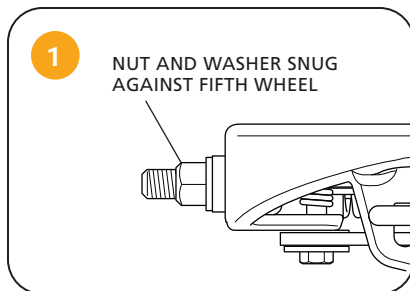

Lock Adjustment Nut and washer **MUST** be snug against the front of the fifth wheel casting. (FW35 model only)

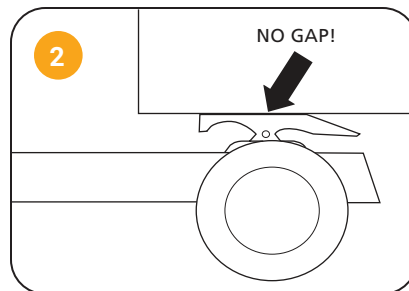

No gap is permissible between the trailer upper coupler plate and the fifth wheel.

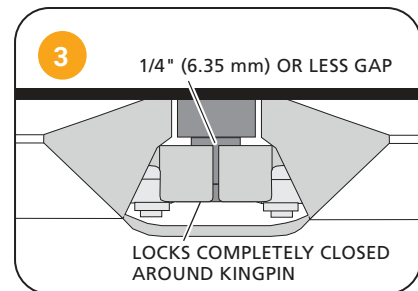

Fifth wheel locks **MUST** be closed around the trailer kingpin with 1/4" (6.35 mm) or less gap visible between the lock jaws. (FW35 model shown)

HOLLAND fifth wheels are supported with operational and maintenance manuals and videos easily accessible on the internet.

[safholland.com](http://safholland.com)

**SAF-HOLLAND, Inc.**  
Tel 800.876.3929

**SAF-HOLLAND Mexico**  
+(52) 55.5362.8743

**SAF-HOLLAND Canada Limited**  
Woodstock 519.537.3494  
Cambridge 519.621.3924  
Surrey 604.574.7491



For more HOLLAND  
Fifth Wheel information.

